



158 TWICKENHAM ROAD

ISLEWORTH, TW7 7DL

£414,950
LEASEHOLD

Nestled on Twickenham Road in the charming area of Isleworth, this delightful flat offers a perfect blend of comfort and modern living. Spanning an impressive 969 square feet, the property boasts two generously sized bedrooms and two well appointed bathrooms, making it an ideal choice for first time buyers seeking ample space.

As you enter, you will be greeted by an exceptionally spacious reception room, perfect for entertaining guests or enjoying quiet evenings at home. The property features inviting balconies that provide a lovely outdoor space to relax and soak in the surroundings.

Security and convenience are paramount, with a gated entrance ensuring peace of mind and an underground parking space that adds to the practicality of this home.

This property is not just a flat, it is a wonderful opportunity to create a warm and welcoming environment in a sought after location. With its modern amenities and spacious layout, it is sure to appeal to those looking to establish their first home in a vibrant community.



Holme Court, Islewprth

Approximate Gross Internal Area
969 sq ft - 90 sq m

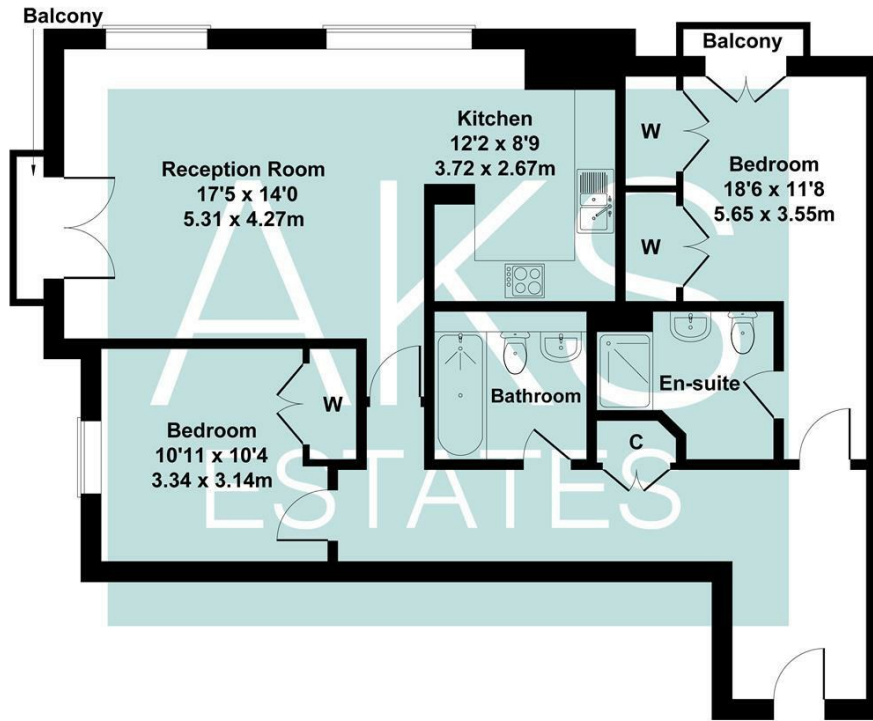

Not to Scale. Produced by The Plan Portal 2025
For Illustrative Purposes Only.

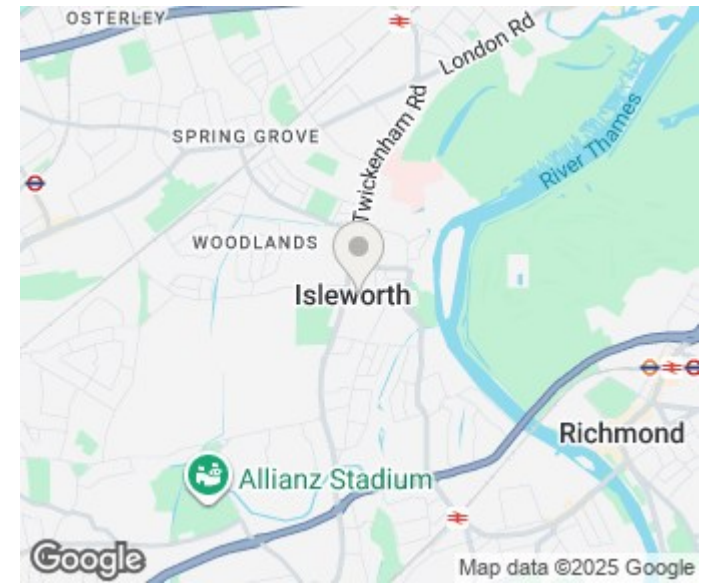

Energy Efficiency Rating		
	Current	Potential
Very energy efficient - lower running costs		
(92 plus) A		
(81-91) B		
(69-80) C	80	83
(55-68) D		
(39-54) E		
(21-38) F		
(1-20) G		
Not energy efficient - higher running costs		
England & Wales	EU Directive 2002/91/EC	

Agents Note: Whilst every care has been taken to prepare these particulars, they are for guidance purposes only. All measurements are approximate and are for general guidance purposes only and whilst every care has been taken to ensure their accuracy, they should not be relied upon and potential buyers/tenants are advised to recheck the measurements

Heston
131A Heston Road
Hounslow
TW5 0RF

020 8059 0595
shiv@aksestates.co.uk
aksestates.co.uk

AKS
ESTATES